



The Badminton

The Badminton's open plan lounge-diner maximises the potential for space, whilst the kitchen has all the amenities required in a modern household. With your comfort in mind, the master bedroom boasts a much welcomed en-suite and walk-in wardrobe.

A lot of thought has gone into the design and build of the Badminton park home range to maximise its potential. So much so that the home works well in a variety of sizes.

As with all our park homes, there's a wide range of options for you to choose from to help make your home unique to you.

Home Details

Price from: £315,000

Home Type: Residential

Bedrooms: 2/3

Pitch Fee: £189 p.c.m

Ongoing living costs/info:

Gas supplied by Calor - Bulk Tank

Council Tax - Band 'A'

Electricity paid to main supplier

Water & Sewerage billed Quarterly

- 10 year warranty
- Gas Central Heating
- PVCu double glazing
- En-suite shower room
- Fully integrated kitchen
- Living room approx: 14' x 21'
- Kitchen area approx: 12' x 9'
- Bedroom 1 approx: 10' x 9'
- Bedroom 2 approx: 12' x 9'



Available in a range of sizes:

36 x 20 ft

40 x 20 ft

44 x 20 ft

T 01403 711419 **M** 07958 121 516

E info@oaklandsparkhomes.co.uk **W** www.oaklandsparkhomes.co.uk

Oaklands Park | Emms Lane | Brooks Green | Horsham | West Sussex | RH13 0TR

In association with



Oaklands Park
QUALITY LIVING

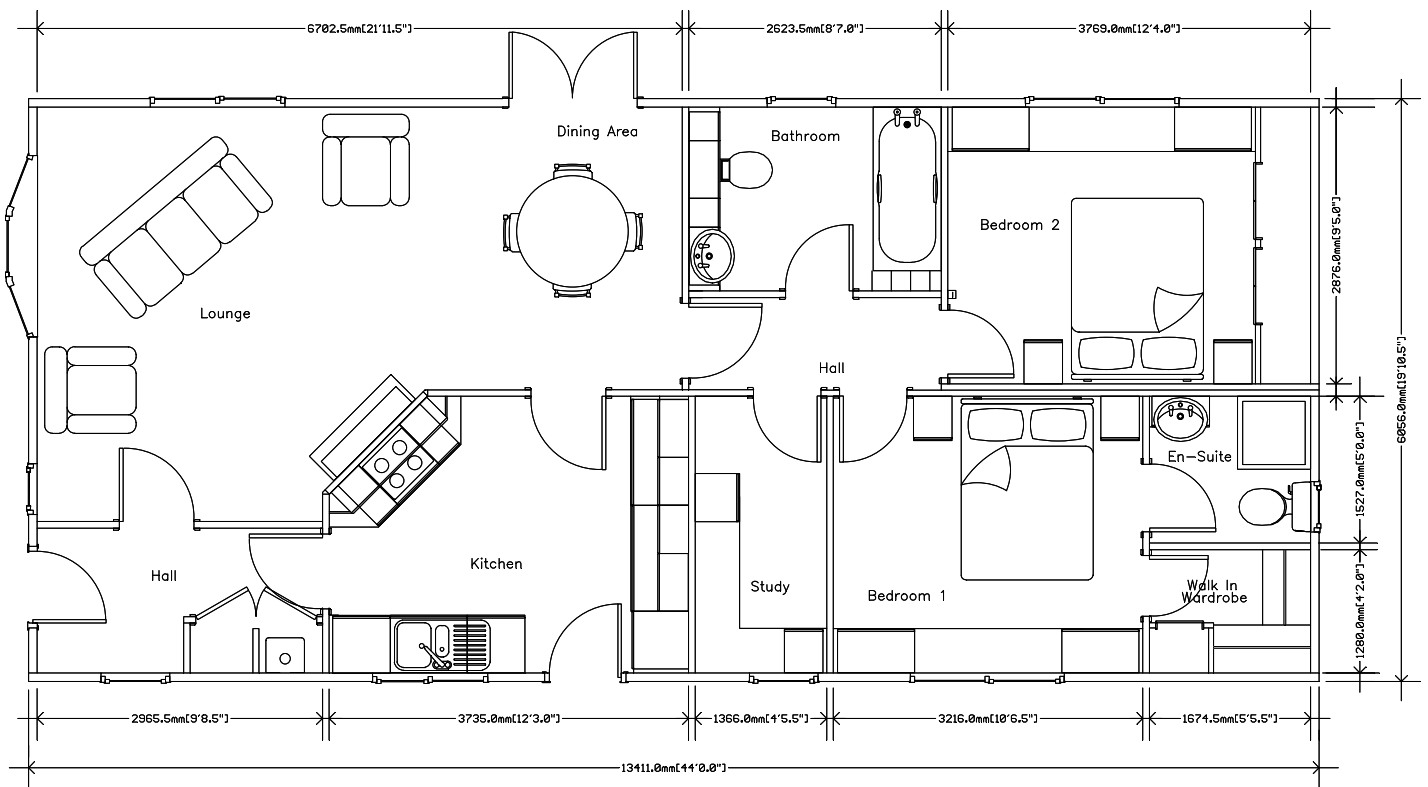

An example layout, more layouts available upon request



“ The Badminton is truly a distinctive and superior home which is sure to appeal to a wide range of tastes. ”

T 01403 711419 M 07958 121 516

E info@oaklandsparkhomes.co.uk W www.oaklandsparkhomes.co.uk

Oaklands Park | Emms Lane | Brooks Green | Horsham | West Sussex | RH13 0TR

In association with



Oaklands Park
QUALITY LIVING