



The Chatsworth - Gold

Externally the 'Gold' benefits from two long bay windows to the side elevation in addition to the two standard bays at the front. The roof line is enhanced by a 3.5 metre gable fitted over the feature front door, with its two glazed side panels, which is available on homes over 42 feet in length.

As with all our park homes, there's a wide range of options for you to choose from to help make your home unique to you.

Home Details

Price from: £299,000

Home Type: Residential

Bedrooms: 2/3

Pitch Fee: £189 p.c.m

Ongoing living costs/info:

Gas supplied by Calor - Bulk Tank

Council Tax - Band 'A'

Electricity paid to main supplier

Water & Sewerage billed Quarterly

- 10 year warranty
- Gas Central Heating
- PVCu double glazing
- En-suite shower room
- Fully integrated kitchen
- Living room approx: 11' x 20'
- Kitchen area approx: 12' x 20'
- Bedroom 1 approx: 13' x 10'
- Bedroom 2 approx: 10' x 10'



Available in a range of sizes:

36 x 20 ft **44 x 20 ft**
40 x 20 ft **48 x 20 ft**

T 01403 711419 **M** 07958 121 516

E info@oaklandsparkhomes.co.uk **W** www.oaklandsparkhomes.co.uk

Oaklands Park | Emms Lane | Brooks Green | Horsham | West Sussex | RH13 0TR

In association with



Oaklands Park
 QUALITY LIVING

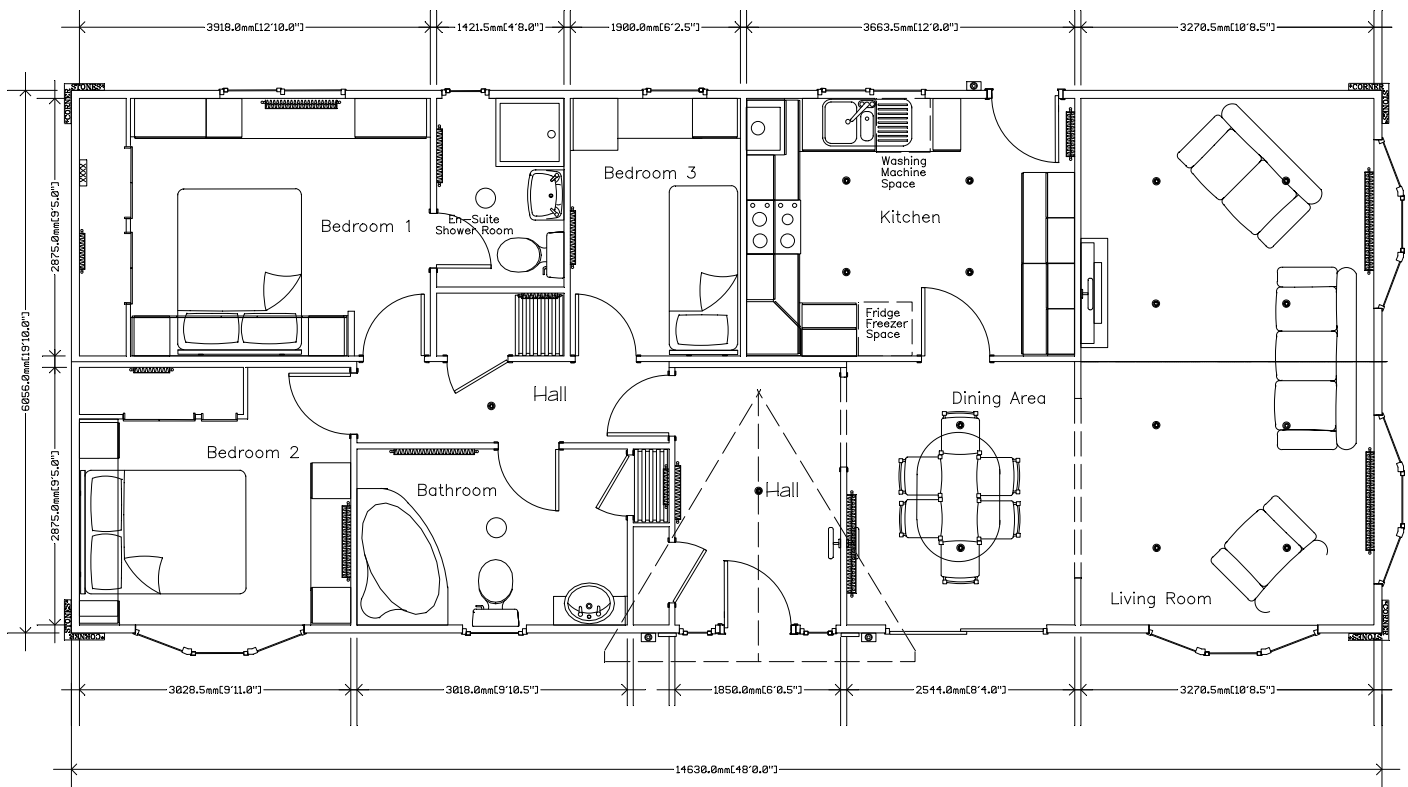

An example layout, more layouts available upon request



“ Designing and building customer-focused homes has always been one of our top priorities. ”