



The Topaz

The main living space in the Topaz park home range is centred around the large and alluring kitchen. With its central island, Range cooker and mantel above, the kitchen boasts functionality and yet is enchanting at the same time.

A feature dressing area with a granite topped central island and feature glazed units either side marks the way for a master bedroom suite unrivalled by other park homes.

The limelight shines down on the bathroom in the Topaz with its signature vanity unit and free standing roll top bath. With a bathroom of this magnitude, you'll be sure to make a splash!

Home Details

Price from: £375,000

Home Type: Residential

Bedrooms: 2/3

Pitch Fee: £189 p.c.m

Ongoing living costs/info:

Gas supplied by Calor - Bulk Tank

Council Tax - Band 'A'

Electricity paid to main supplier

Water & Sewerage billed Quarterly

- 10 year warranty
- Gas Central Heating
- PVCu double glazing
- En-suite shower room
- Fully integrated kitchen
- Living room approx: 12' x 20'
- Kitchen area approx: 11' x 9'
- Bedroom 1 approx: 11' x 15'
- Bedroom 2 approx: 11' x 9'



Available in a range of sizes:

40 x 20 ft

50 x 20 ft

46 x 20 ft

T 01403 711419 **M** 07958 121 516

E info@oaklandsparkhomes.co.uk **W** www.oaklandsparkhomes.co.uk

Oaklands Park | Emms Lane | Brooks Green | Horsham | West Sussex | RH13 OTR

In association with



Oaklands Park
QUALITY LIVING

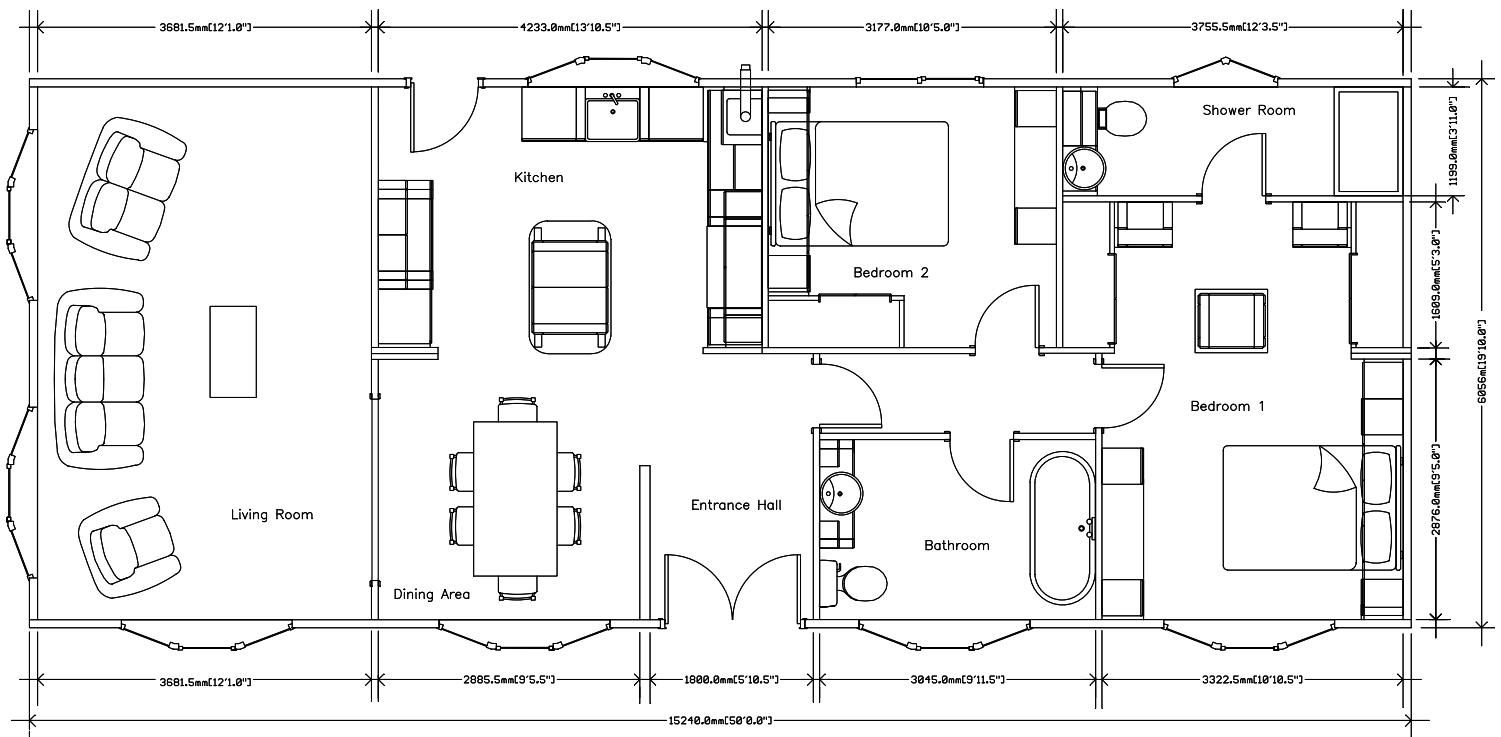

An example layout, more layouts available upon request



“ An ideal place to spend time - even if it's just to watch the World go by. ”